

NEW VOLUMES™

Artemis



Artemis c/o Emma Elizabeth



Raw edges evoke a feeling as if someone has literally hacked into the natural formation of the stone and created the piece themselves.



A minimal expression referencing the traditional way in which solid stone is quarried, the Artemis series of offset candle holders cast non-regular rays of delicate light — aiding ambience at any experiential moment.

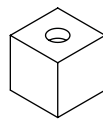

Artemis I
110 x 110 x 110H
4.1kg (approx.)

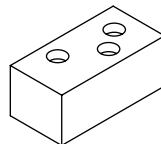

Artemis II
260 x 130 x 110H
8.6kg (approx.)

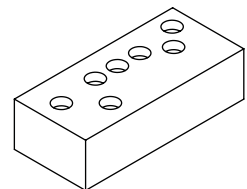

Artemis III
400 x 180 x 110H
19.6kg (approx.)